

Did You Know that you can login to your Online Community with your existing Social Media accounts?

Once social media login is enabled, you may enter the online community with the click of the button.

You may log into your Online Community using the same user account and password from an existing Social Media system through **Twitter, LinkedIn, or Facebook** Social Media. Follow these 5 easy steps to associate your Social Media account with the online community:

1. Login to the online community using your online community user id and password.
2. Go to Your My Profile page and select the Enable Social Login option (on the left side panel).
3. Select the Social Login option for your Login (you can only use one for Twitter, LinkedIn, or Facebook). You may be required to confirm the use via the selected Social Media Option.
4. Confirm the Social Media Login has been established.
5. On your next login to the online community, you can select the Social Media option that you enabled.

Step 1 - Login to the online community using your online community user account and password

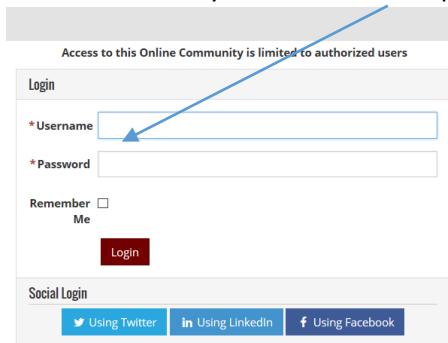

To Enable Social Media Login with Facebook, Twitter or LinkedIn you must login with your community login and connect your account first.

Step 2 - Go to Your My Profile page and select the Enable Social Login option (on the left side panel)

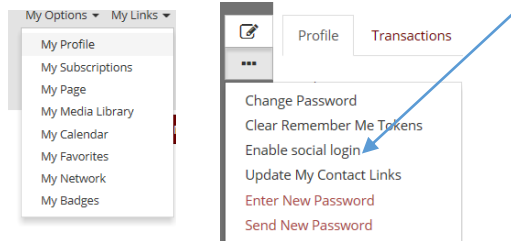

Step 3 - Select the Social Login option for your Login (you can only use one for Twitter, LinkedIn, or Facebook)

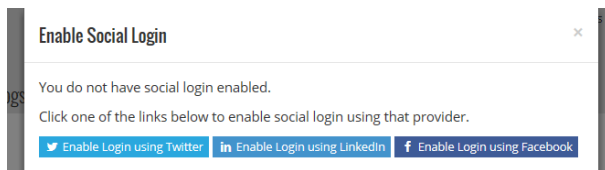

Step 4 - Confirm the Social Media Login has been established

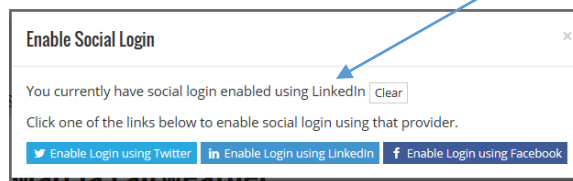

Step 5 - On your next login to the online community, you can select the Social Media option that you enabled. The regular account option is also still available. Login Here

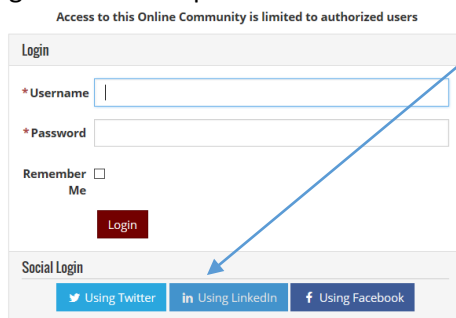

To Enable Social Media Login with Facebook, Twitter or LinkedIn you must login with your community login and connect your account first.

Once you are logged into the Home Page click **“Community”** to engage with your individual program

